

**IN-SITU CONCRETE**

**BLOCK PAVING**

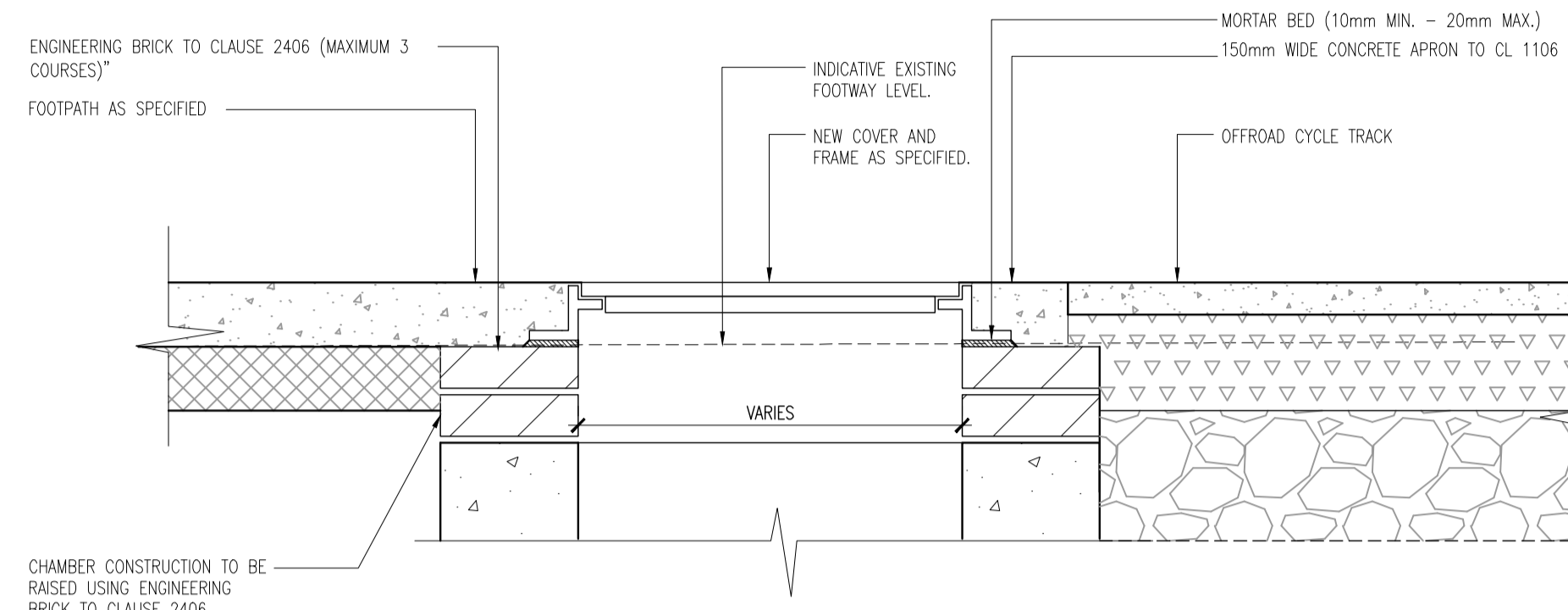

**LEVEL ADJUSTMENT OF EXISTING CHAMBERS IN FOOTWAY / CYCLEWAY**  
SCALE 1:10

**FIGURE 2A**

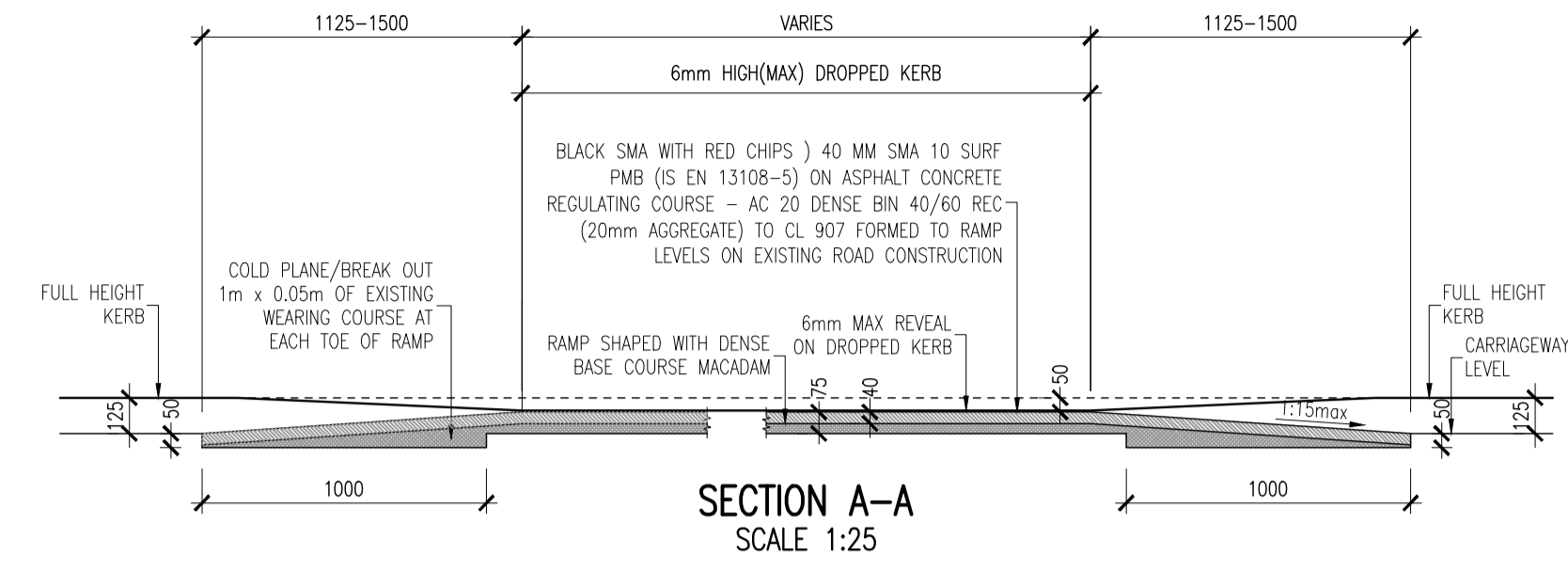

**SECTION A-A**  
SCALE 1:25

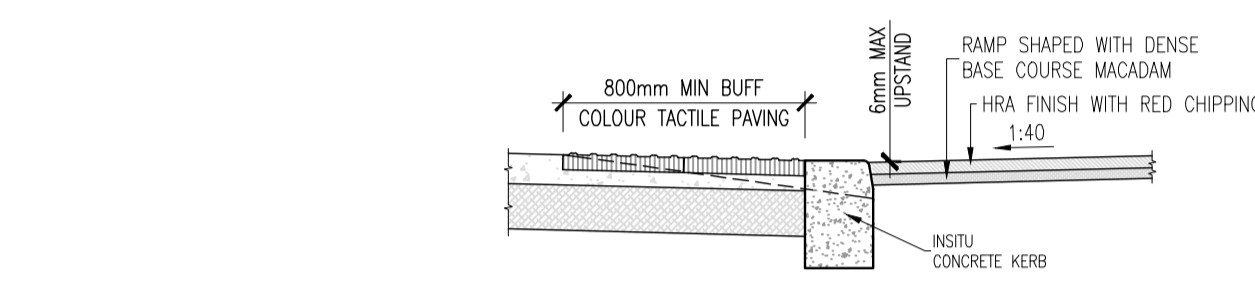

**SECTION B-B**  
SCALE 1:25

**FIGURE 2B**

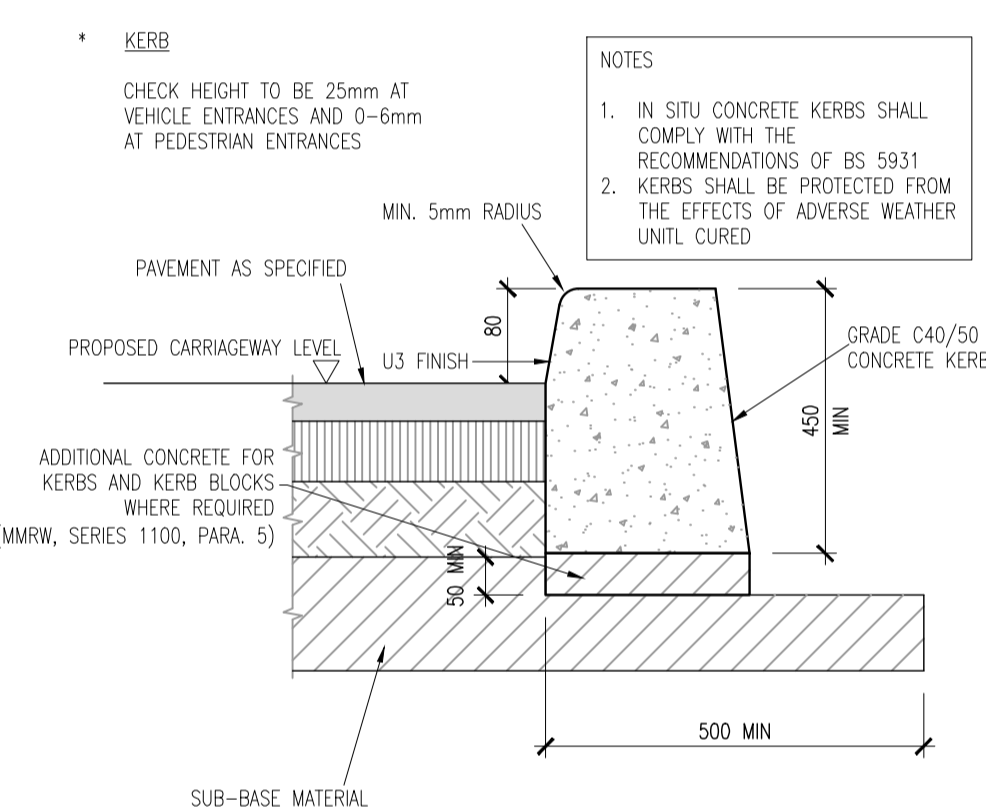

**INSITU CONCRETE KERB DETAIL**  
SCALE 1:10

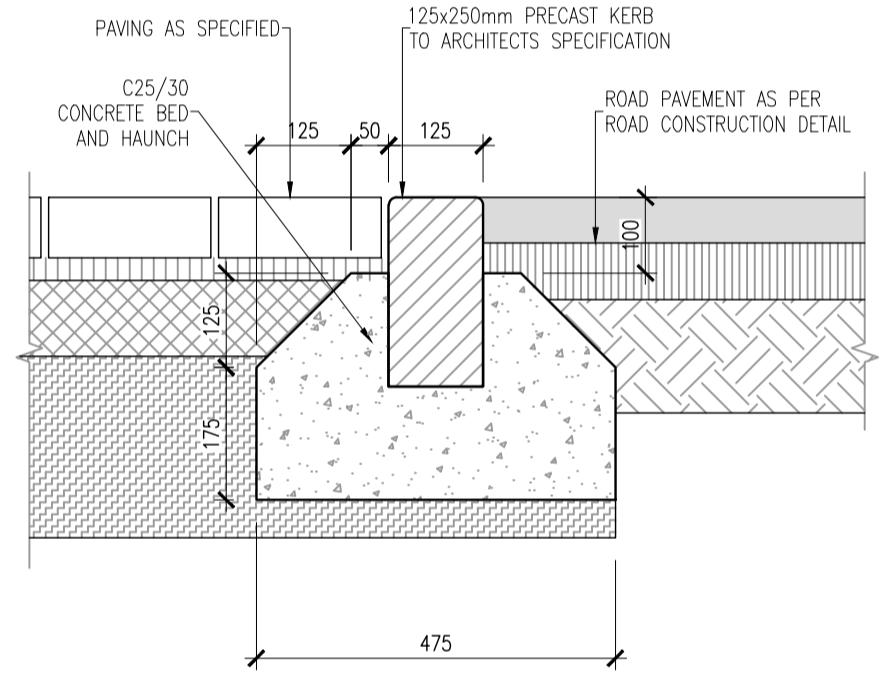

**EDGE KERB DETAIL (DBM TO PAVING BLOCK)**  
SCALE 1:10

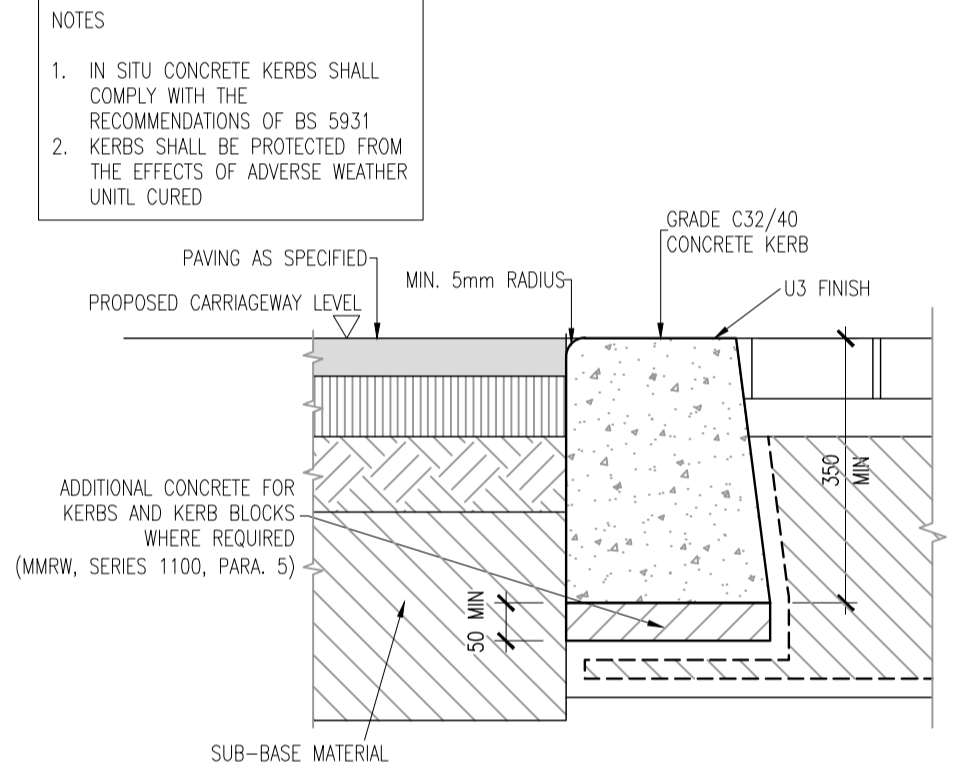

**FLUSH KERB DETAIL**  
SCALE 1:10

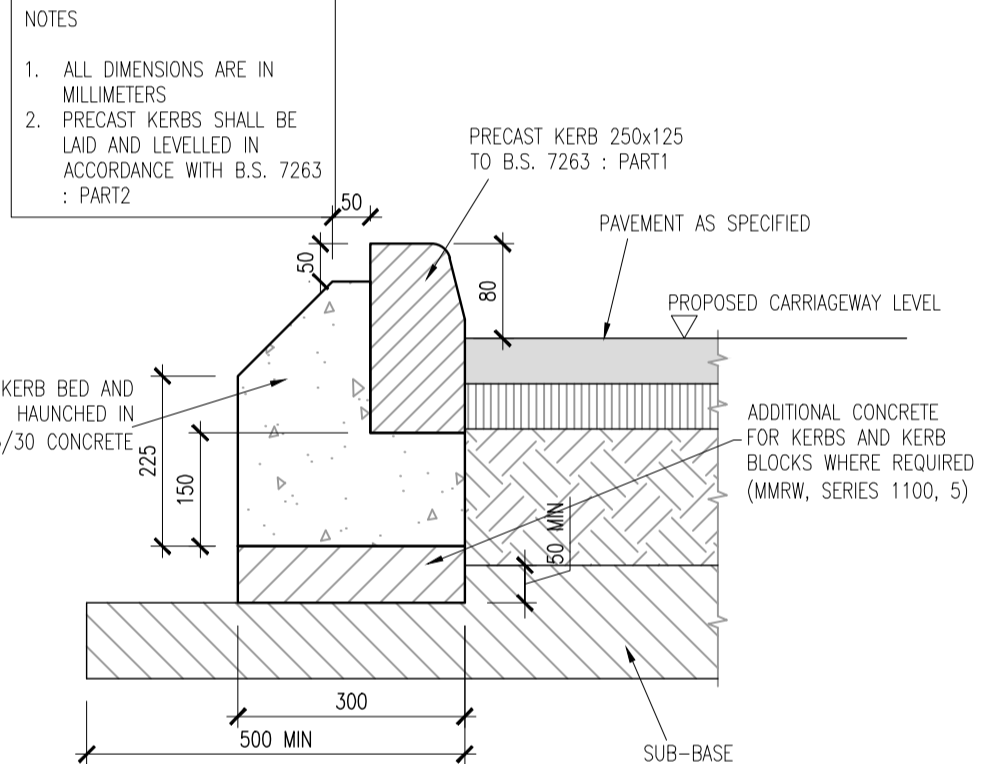

**PRECAST KERB DETAIL**  
SCALE 1:10

**FIGURE 2C**

ON ORIGINAL

0 5 10 15 20 25 30 40 50mm

© COPYRIGHT OF THIS DRAWING IS RESERVED BY DBFL CONSULTING ENGINEERS. NO PART SHALL BE REPRODUCED OR TRANSMITTED WITHOUT THEIR WRITTEN PERMISSION.

NO CHANGES OF WHATSOEVER NATURE ARE TO BE MADE TO ANY DETAILS SET OUT OR CONTAINED IN ANY DBFL SPECIFICATIONS OR DRAWINGS UNLESS THE EXPRESS CONSENT HAS BEEN OBTAINED IN ADVANCE, IN WRITING, FROM DBFL.

NOTES:

GENERAL NOTES:

1. THE SPECIFICATION REFERRED TO IN THE CONTRACT SHALL BE THE SPECIFICATION FOR ROAD WORKS IN THE TI PUBLICATIONS.
2. ALL WORKS SHALL BE CONSTRUCTED IN ACCORDANCE WITH THE WORKS REQUIREMENTS.
3. ALL DIMENSIONS IN METRES UNLESS SPECIFIED OTHERWISE.
4. ALL CO-ORDINATES ARE TO IRISH TRANSVERSE MERCATOR.
5. ALL LEVELS ARE TO ORDNANCE DATUM (M.A.S. HEAD).
6. ALL TEMPORARY TRAFFIC MANAGEMENT SHALL COMPLY FULLY WITH THE WORKS REQUIREMENTS - REFER TO APP 1/17.
7. THE CONTRACTOR MUST LAISE DIRECTLY WITH SDDC ROADS DEPARTMENT AS DIRECTED IN THE WORKS REQUIREMENTS.
8. ALL VEHICULAR, PEDESTRIAN & CYCLE ROUTES WITHIN AND SURROUNDING THE WORKS EXTENTS MUST BE MAINTAINED THROUGHOUT THE WORKS IN ACCORDANCE WITH THE CONTRACTORS APPROVED TEMPORARY TRAFFIC & OPERATIONS MANAGEMENT PLAN.
9. ALL PERMANENT TRAFFIC MANAGEMENT TO BE CONCEALED/REMOVED OR INCORPORATED INTO THE CONTRACTORS TEMPORARY TRAFFIC MANAGEMENT PLAN THROUGHOUT WORKS AND TRANSFERRED ONLY WHEN AGREED WITH SDDC TRAFFIC DEPARTMENT.
10. ALL AGGREGATES PROPOSED FOR USE ON THIS SCHEME SHALL MEET FULLY THE REQUIREMENTS OF THE CONTRACT SPECIFICATION AND IN ADDITION THE REQUIREMENTS STATED IN STANDARD RECOMMENDATION S.R. 21:2014 GUIDANCE ON THE USE OF U.S. EN 13242:2002 (A1:2007) - AGGREGATES FOR UNBOUND AND HYDRAULICALLY BOUND MATERIALS FOR USE IN CIVIL ENGINEERING WORK AND ROAD CONSTRUCTION. FURTHER DETAIL IS PROVIDED IN ADDITIONAL CLAUSE 1444R OF THE CONTRACT SPECIFICATION.

DRAWING SPECIFIC NOTES:

1. ALL REFERENCES TO SERIES 900 OF NRA SPECIFICATION, REFER TO SERIES 900 DATED DECEMBER 2014.

LIST OF NRA ROAD CONSTRUCTION DETAILS BROUGHT INTO THE CONTRACT

RCD 300/1	TIMBER POST & RAIL FENCE - TYPES A & B
RCD 300/11	TIMBER SINGLE FIELD GATE
RCD 400/1	PEDESTRIAN GUARD RAIL
RCD 500/1	CHAMBER TYPES
RCD 500/2	CHAMBER TYPE A (BLOCK OR INSITU CONCRETE)
RCD 500/3	CHAMBER TYPE B (BLOCK OR INSITU CONCRETE)
RCD 500/4	CHAMBER TYPE C (PRECAST CONCRETE MANHOLE)
RCD 500/5	CHAMBER TYPE D (PRECAST CONCRETE MANHOLE)
RCD 500/6	CHAMBER TYPE E (PRECAST CONCRETE MANHOLE)
RCD 500/7	CHAMBER TYPE E (TYPICAL HINGED GRATING DETAIL)
RCD 500/8	VERTICAL BACKSTOP MANHOLES
RCD 500/9	CHAMBER TYPE F (PRECAST CATCHPIT)
RCD 500/10	PRECAST CONCRETE GULLY
RCD 500/11	INSITU CONCRETE & BLOCKWORK GULLIES
RCD 500/12	GULLY GRATING
RCD 500/13	CHAMBER FITTINGS - LADDER HAND HOLD AND SAFETY CHAIN
RCD 500/14	TYPICAL CHAMBER DETAILS
RCD 500/20	FILTER DRAINS - TRENCH & BEDDING DETAILS
RCD 500/21	DETAILS
RCD 500/24	DIAGRAMMATIC LAYOUT AT HEADWALLS
RCD 500/51	SELF CLEARING INLET GRID DETAIL
RCD 500/52	OUTLET GRID DETAIL
RCD 500/53	CA OF FORMED HEADWALLS (INTERCEPTOR DRAINS)
RCD 500/60	TRANSVERSE DUCTS
RCD 500/61	TRENCH CROSS-SECTIONS UNDER TRAFFICKED AREAS
RCD 500/62	TRENCH CROSS-SECTIONS UNDER NON-TRAFFICKED AREAS
RCD 500/63	DUCT CROSSING TYPES
RCD 500/64	FOOTWAY/AVERAGE DRAW PIT
RCD 500/65	CARRIAGEWAY DRAW PIT - TYPE A
RCD 600/1	TRANSITION AREA BETWEEN CUT AND FILL
RCD 600/2	INTERCEPTOR DITCHES
RCD 700/2	KERBED PAVEMENT EDGE DETAIL
RCD 700/3	TRANSVERSE JOINT BETWEEN NEW CONSTRUCTION AND EXISTING ROAD
RCD 700/4	LONGITUDINAL JOINT BETWEEN NEW CONSTRUCTION AND EXISTING ROAD
RCD 700/5	TRENCH REINSTATEMENT
RCD 700/6	ACCESS ROAD / SERVICE ROAD
RCD 1000/2	EXPANSION JOINTS
RCD 1000/3	CONTRACTION JOINTS
RCD 1000/6	TRANSITION FROM RIGID TO FLEXIBLE CONSTRUCTION
RCD 1100/2	INSITU CONCRETE KERB
RCD 1100/3	DROPPED KERB RAMP
RCD 1100/4	BITUMINOUS FOOTWAY
RCD 1100/5	CONCRETE FOOTWAY
RCD 1100/7	NOSING DETAIL

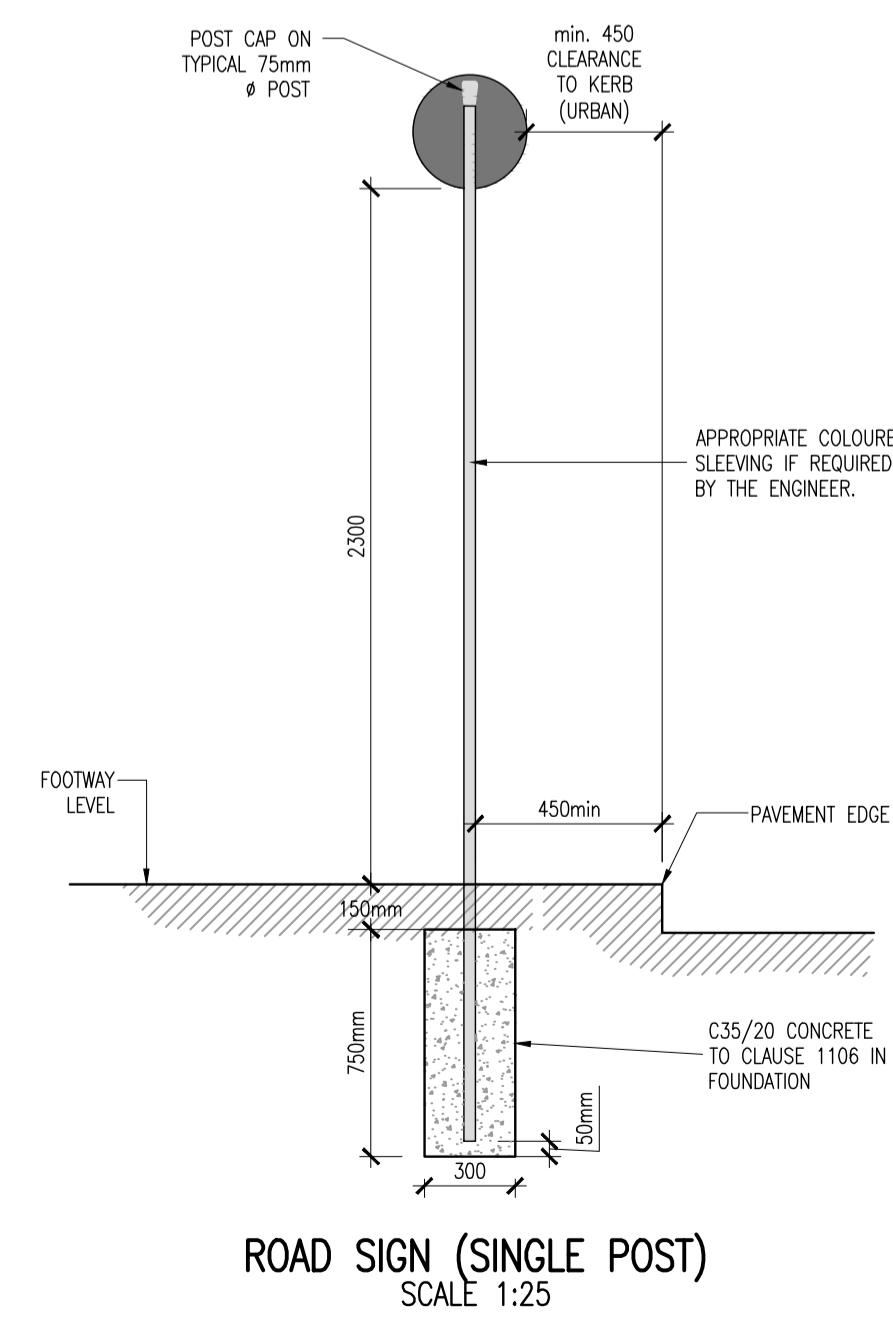

**FIGURE 2D**

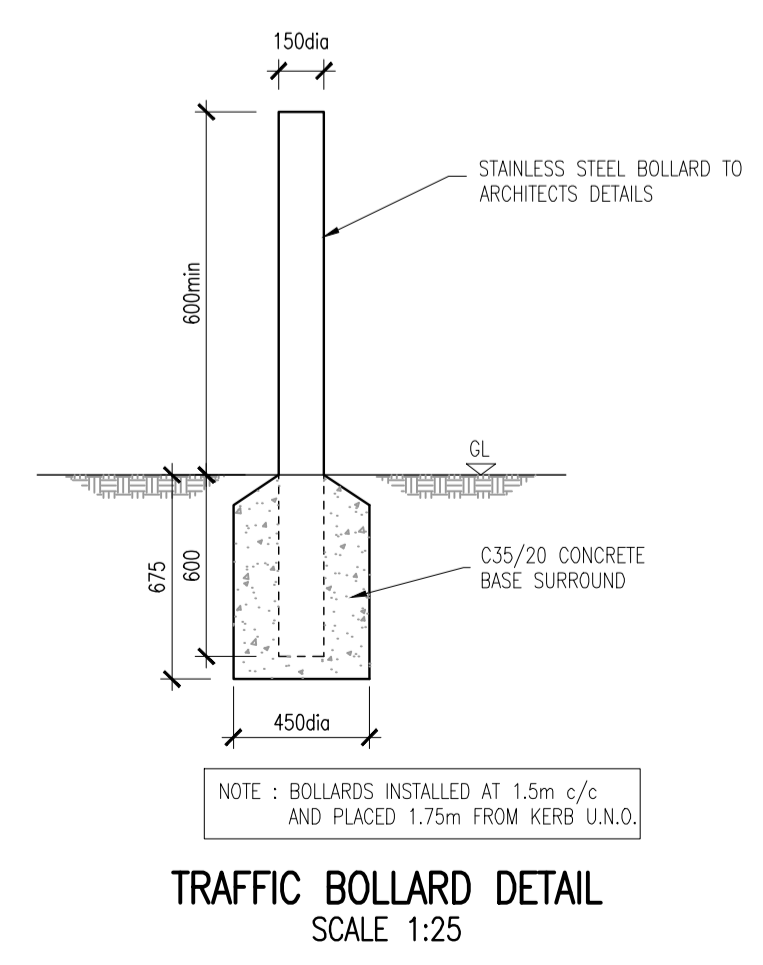

**FIGURE 2E**

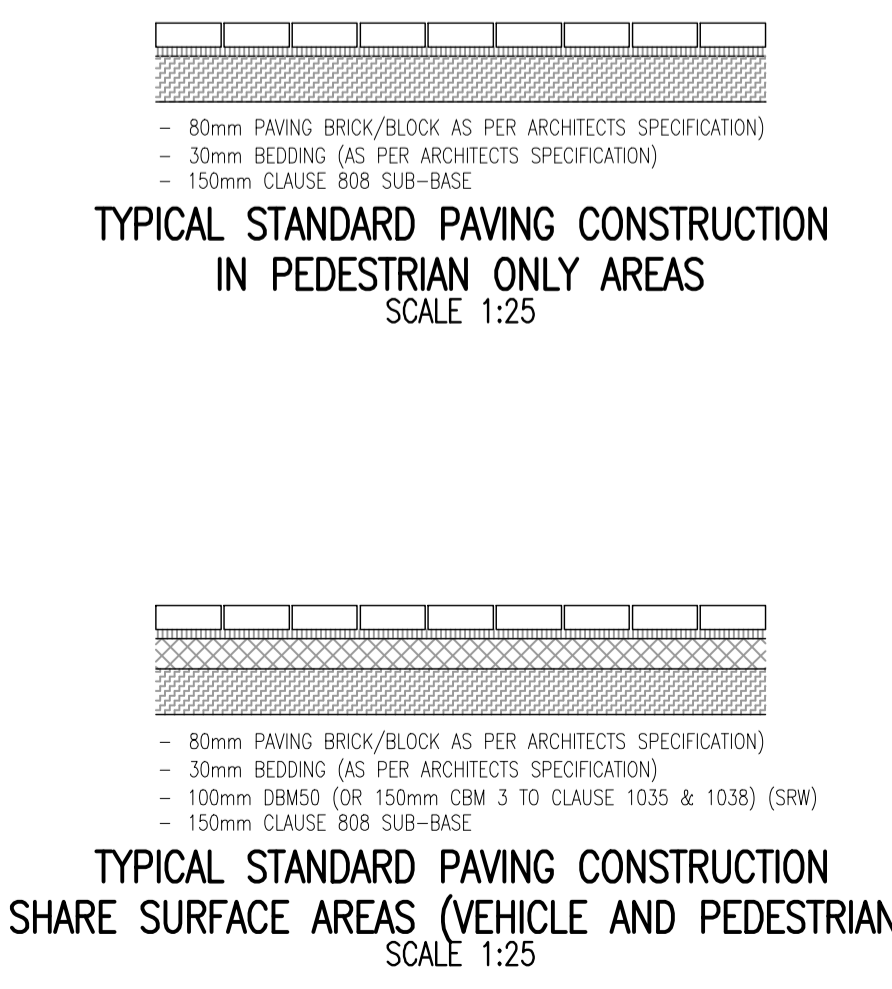

**FIGURE 2F**

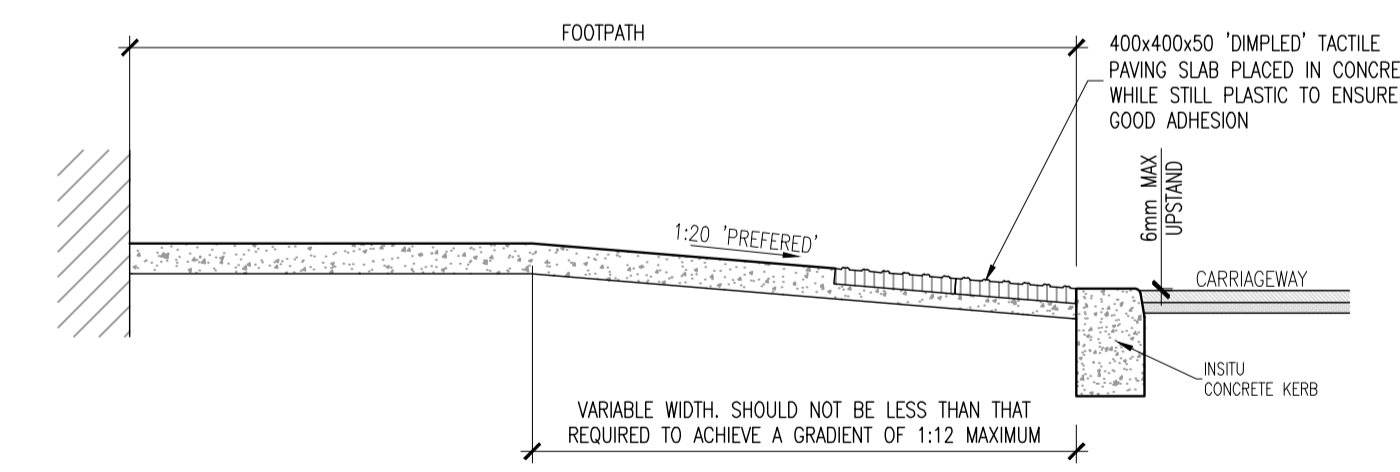
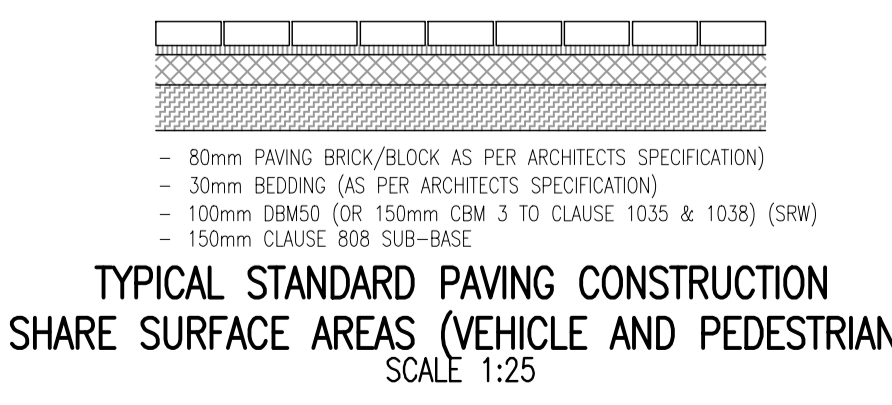

**TYPICAL SECTION THROUGH DISHED CROSSING**  
SCALE 1:25

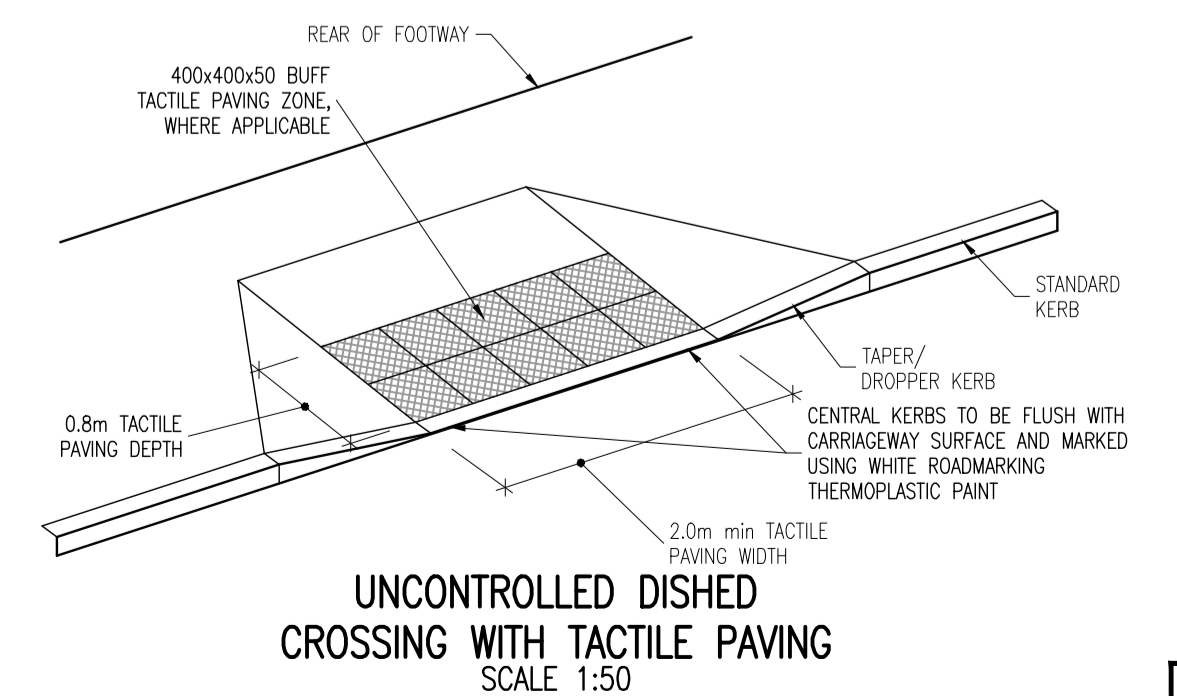

**FIGURE 2G**

rev	date	description	by	chkd.
A-		Approved		
B-		Approved with comments		
C-		Do not use		
suitability		issue purpose		
S2 - INFORMATION		PLANNING		
<b>DBFL Consulting Engineers</b> Civil, Structural & Transportation Engineering www.dbfl.ie				
DUBLIN OFFICE: Ormond House, Upper Ormond Quay, Dublin 7. D07 W7X4 PHONE: +353 1 400 4000				
CORK OFFICE: 14 South Mall, Cork. T12 CT91 PHONE: +353 21 2024538				
WATERFORD OFFICE: Suite 10 The Arkum, Marlboro Gate, Canada Street, Waterford. X91 W028 PHONE: +353 51 309 500				
project ref.				
WHITE PINES CENTRAL RESIDENTIAL DEVELOPMENT				
drawing title				
TYPICAL CONSTRUCTION DETAILS SHEET 2				
client				
ARDSTONE HOMES				
designed by	author	scale	sheet size	
SPB	JVS	AS SHOWN	A1	
drawing no.	revision			
190004-DBFL-RD-SP-DR-C-5002	PO			